

Stepper MOTOR

28SH45 High Torque Hybrid

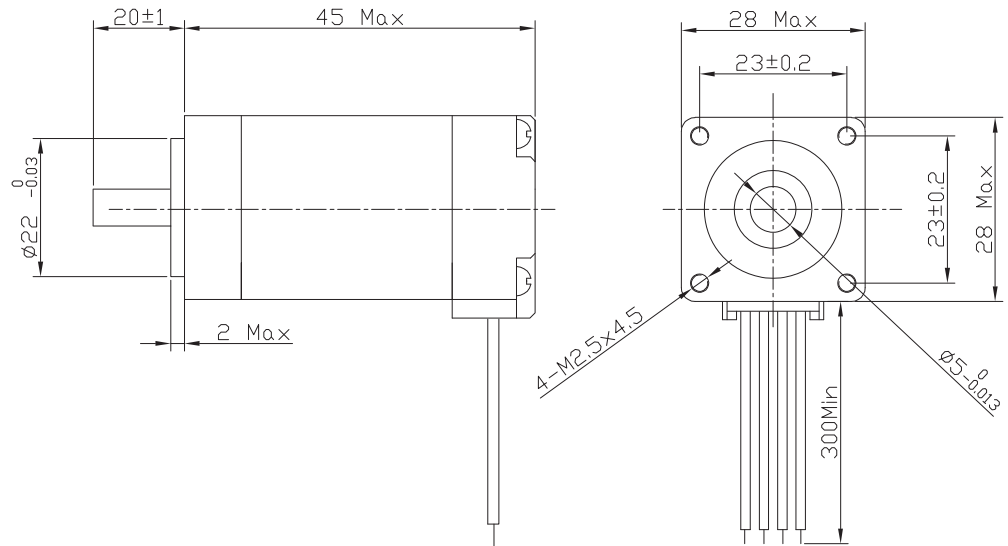

BE version: rear shaft 13mm- 2x M2.5 on diam. 19.05 mm

Characteristics

STEP ANGLE
1,8°

STEP ANGLE ACCURACY
± 5%

INSULATION CLASS
B

AMBIENT TEMPERATURE
-20°C +50°C

TEMP. RISE
80°C MAX (RATED CURRENT, 2 PHASE ON)

INSULATION RESISTANCE
100 M OHM MIN. 500 VDC

FIELD ELECTRIC STRENGTH
500 VAC FOR ONE MINUTE

SHAFT RADIAL PLAY
0,02 MAX (450 G LOAD)

SHAFT AXIAL PLAY
0,08 MAX. (450 G LOAD)

MAX RADIAL FORCE
28 N (20 MM FROM FRONT FLANGE)

MAX AXIAL FORCE
10 N

Specification

Model		28SH45-0956A	28SH45-0674A
1 RATED VOLTAGE	V	3,4	4,56
2 CURRENT/PHASE	A	0,95	0,67
3 RESISTANCE/PHASE	Ω	3,4	6,8
4 INDUCTANCE/PHASE	mH	1,2	4,9
5 HOLDING TORQUE	Nm	0,075	0,095
6 ROTOR INERTIA	g·cm ²	12	12
7 WEIGHT	Kg	0,14	0,14
8 NUMBER OF LEADS	N°	6	4

Speed vs. Torque Characteristics

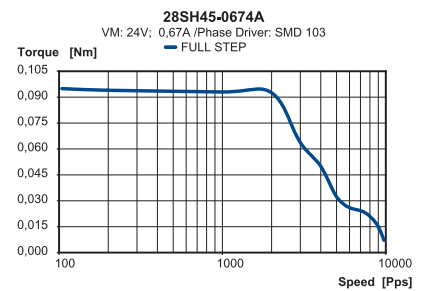
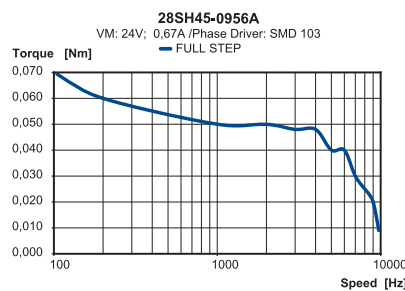

Connection

LEAD N°	COLOR	GAUGE	FUNCTION
1	BLACK	UL1061 AWG26	PHASE A
2	GREEN	UL1061 AWG26	PHASE A-
3	RED	UL1061 AWG26	PHASE B
4	BLUE	UL1061 AWG26	PHASE B-
UNIPOLAR MOTOR			
5	YELLOW	UL1061 AWG26	COM PHASE A
6	WHITE	UL1061 AWG26	COM PHASE B

